

1/2, 1, 1 1/2, 2, & 3 HP, TEFC Motor, 3450 RPM
UL/CSA Approved

Discharge

Back side - mount to wall or column

Bracket is fabricated from 12 ga mild steel and reinforced with 1"x1" square tube. The assembly is finished with a zinc plating.

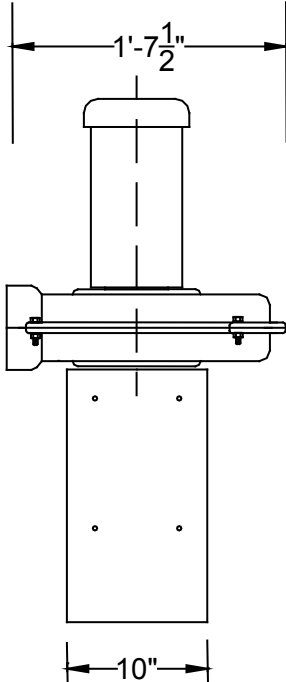

The blower can be rotated 360 degrees in 90 degree increments. This allows for discharge for a variety of requirements.

The blower inlet can be supplied with a number of inlet fittings.

4 - laser cut mounting holes - 1/2"

Note: Overall height varies based on motor selection.

Rear View

1 Phase: 115/208/230 Volt
3 Phase: 208/230/460 Volt